



KEITH TIMBER
Frames Trusses

Phone: (08) 8755 1233
13 Park Terrace Keith S.A. 5267

Winner of Multiple FTMA Awards
Since 2007



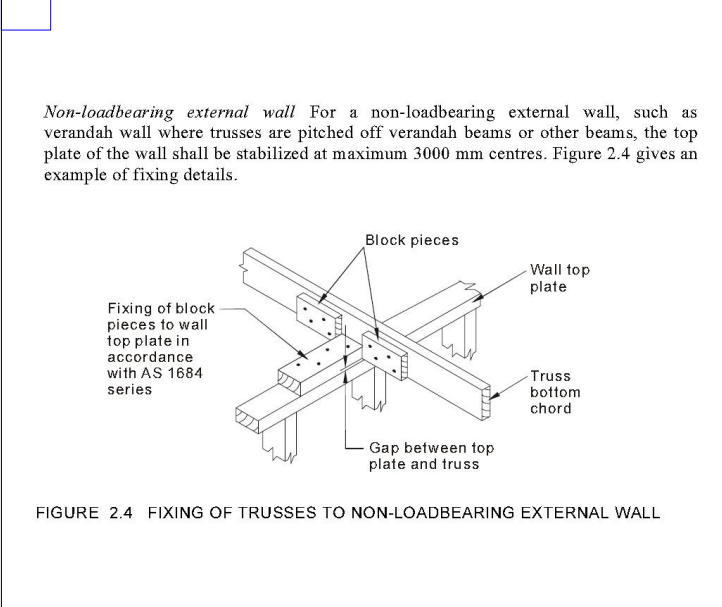
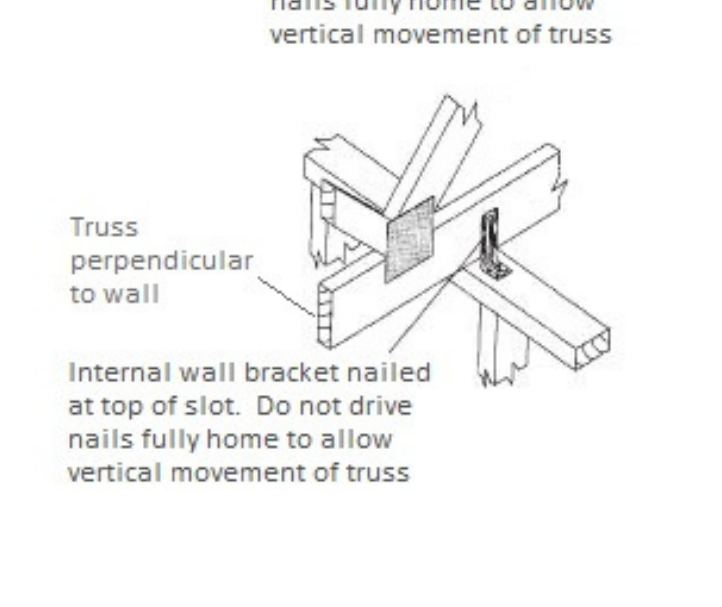
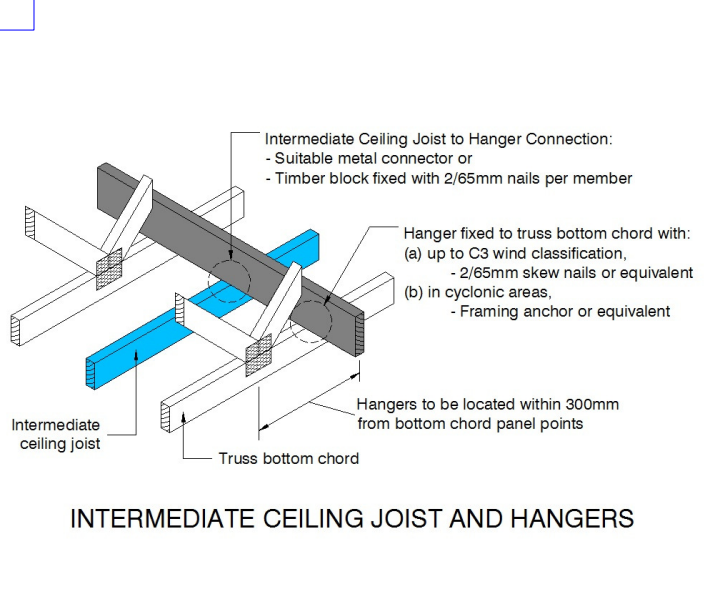
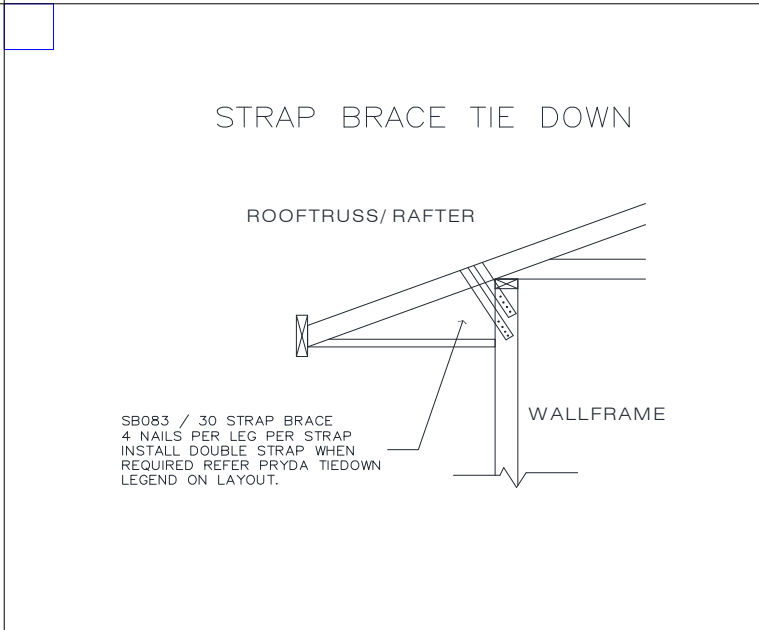
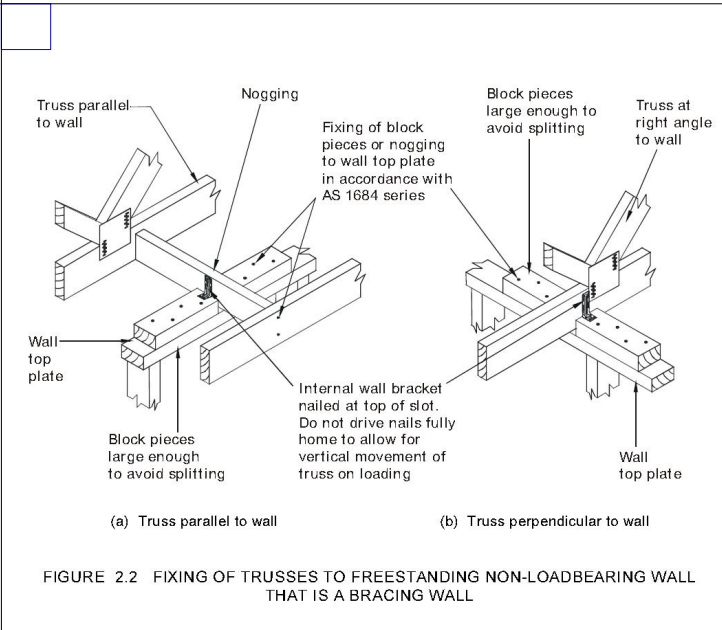
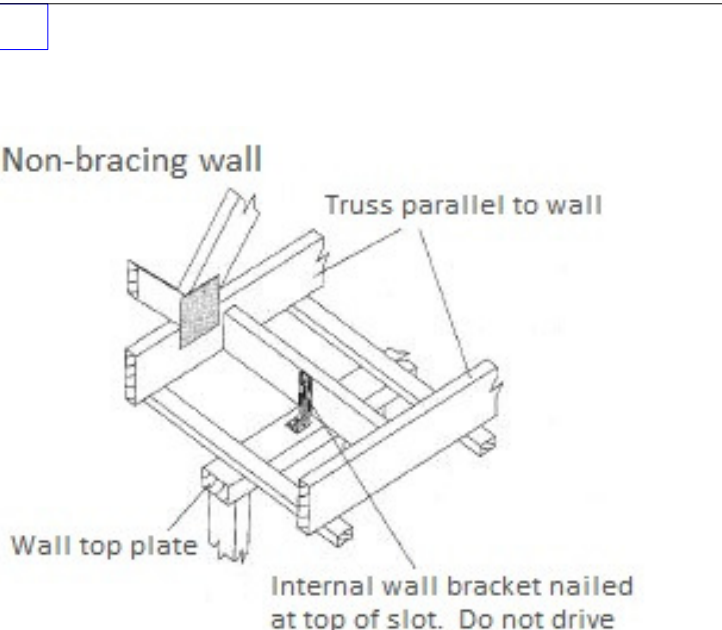
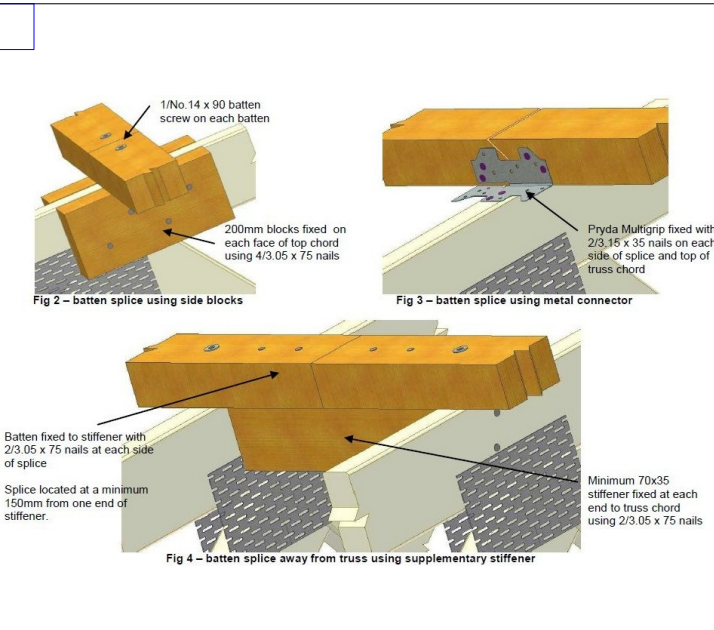
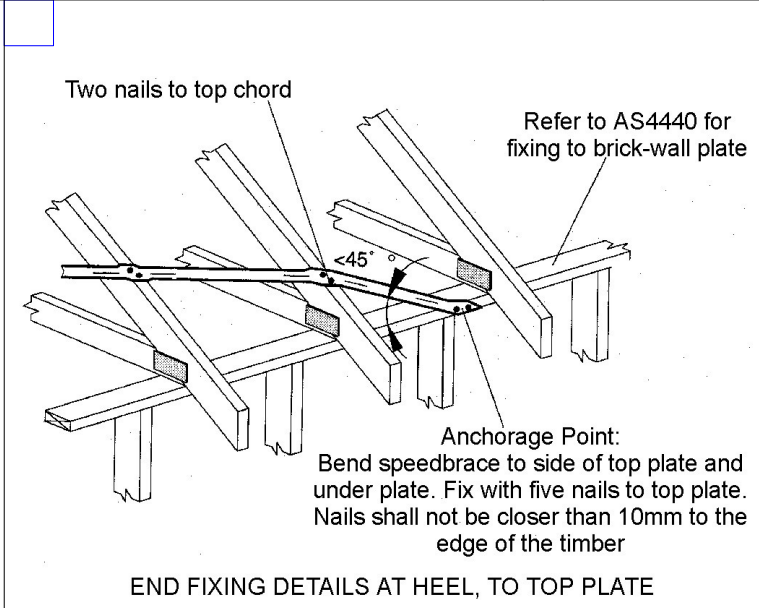
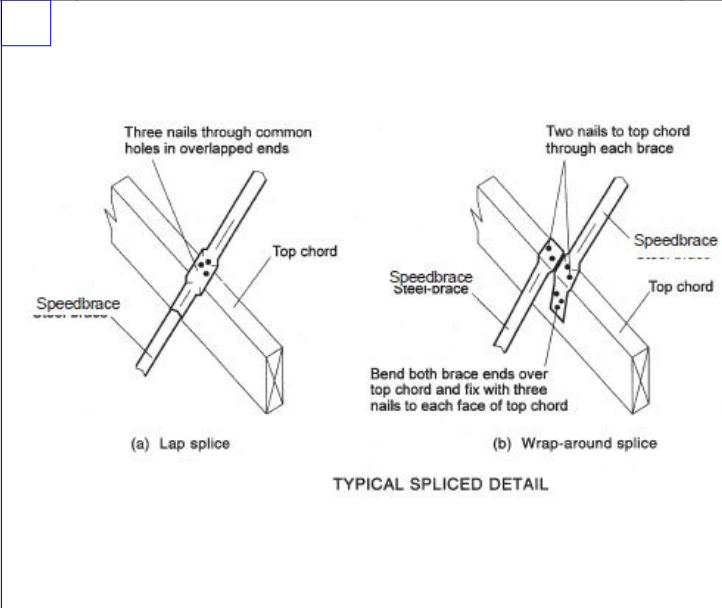
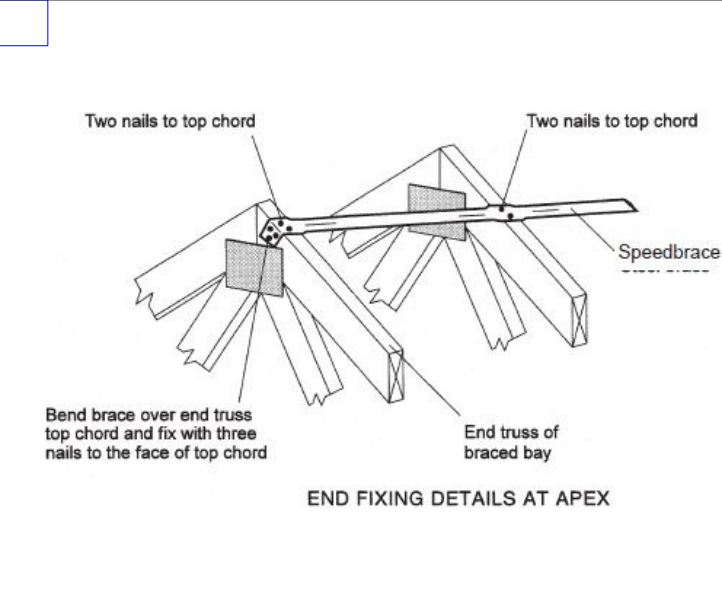

Pryda Timber Connector Nails

For fixing of all Pryda Bracings, it is essential to use galvanised **Pryda Timber Connector Nails**, ie: the special 35x3.15 mm nails developed by Pryda specifically for fixing of our products. Laboratory strength testing has shown that clouts are not adequate for this purpose as their heads may pop off under less than design load.

Machine Driven Nail Use

Where appropriate, 32x2.3 mm Duo-Fast C SHEG (ie: screw hardened electro galvanized) machine driven nails (code D40810) or equivalent may be used instead of the specified 35x3.15 mm Pryda Timber Connector Nails to fix Pryda connectors provided that:

- 20% more nails are used (eg: 5 instead of 4, 4 instead of 3, 3 instead of 2) or alternatively, design capacities are to be reduced by 20% where the same number of nails are used
- machine driven nails are driven at nail spacings and edge distances similar to the hole pattern, ensuring that these nails are not driven into the holes or located not closer than 5mm from the edge of a hole.

	<div>Customer : Pine Timber (Acc 1)</div> <div>Site Address : BERT FARINA CONSTRUCTION</div> <div>: 147 MARION ROAD, RICHMOND</div>	<div>Roofing : Sheet steel (0.48mm)</div> <div>Pitch : 60.00 Deg.</div> <div>Spacing : 1200</div> <div>Design Wind Velocity : 40.00 m/s (Ult.)</div> <div>Detailer : Adam Koziol</div>	<div>Job Ref 16-1021</div> <div>Scale N.T.S</div> <div>Level</div>
--	---	--	--